

Waterside space specifications

WATERSHED

Watershed Events Department Tel: 0117 927 2082 Fax: 0117 921 3958 Email: events@watershed.co.uk

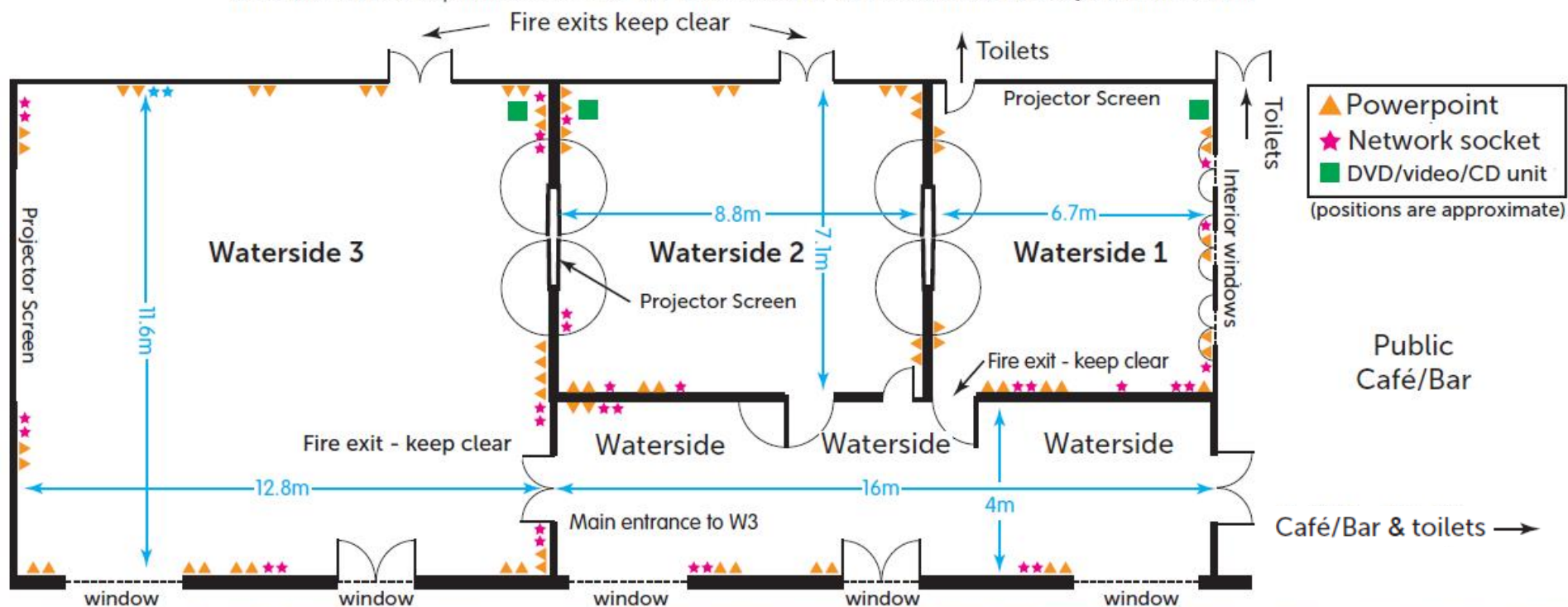

Waterside 3

This space seats up to 120* people and has a 13ft x 9ft projector screen and black-out facility. The room has an attractive beamed ceiling with skylights and is equipped with PA speakers, mixing desk, a full HD 1080p projector and a computer input.



Waterside 2

With the capacity of up to 40* people this space is equipped with an 8.5ft x 6ft retractable projector screen, black-out facility, PA speakers and a computer input.



Waterside 1

This space seats up to 30* people and has a 85" HD 4K LCD screen and black-out facility. It is equipped with PA speakers and a computer input.



Waterside

This space, usually open to the public, can also be used for large events. It can be used as an event reception, breakout area or exhibition space.

* Capacity will vary depending on room layout